

IT

COMPACT nasce per offrire in un'unica soluzione tutti i vantaggi e la praticità di una postazione di lavoro ILSA per la preparazione di pizze, panini, insalate, tramezzini ecc. Un solo motore alimenta elemento refrigerato ed espositore bacinelle, consentendo una notevole riduzione delle dimensioni.

- Finitura esterna satinata scotch-brite;
- spessore di isolamento di 60mm per la scocca e 50mm per le porte con schiumatura ad alta densità (40 kg/mc);
- schiena esterna in acciaio inox AISI 304 scotch-brite;
- piedini in acciaio inox regolabili in altezza H 140/230mm;
- cella con angoli arrotondati per una migliore pulizia interna;
- porte auto-chiudenti con fermo a 95°;
- guarnizioni magnetiche porta facilmente sostituibili;
- unità refrigerante a monoblocco;
- sistema di ventilazione canalizzata sulla schiena per una perfetta ed omogenea temperatura interna;
- sbrinamento a gas caldo ed evaporazione automatica dell'acqua di condensa;
- maniglie ergonomiche;
- alimentazione standard 230V/50Hz;
- gas refrigerante R290;
- cerniere porte superiori ed inferiori fissate frontalmente sulla scocca (intercambiabili senza dover togliere il piano di lavoro);
- porte reversibili.

COMPACT has been designed so to offer, in a unique solution, all advantages and the convenience of a ILSA working systems for the preparation of pizza, rolls, salads, sandwiches, etc. One single drive powers the refrigerated counter and the container display window, allowing a considerable reduction in dimensions.

- External scotch-brite satin finish;
- 60mm insulation thickness for the casing and 50mm for the doors with high density foam (40 kg/mc);
- external back plate in stainless steel AISI 304 scotch-brite;
- feet in stainless steel adjustable in height H 140/230mm;
- cell with rounded corners for a more effective internal cleaning;
- self-closing doors with safety stop at 95°;
- easily removable door magnetic gaskets;
- monobloc refrigerating unit;
- ducted ventilation system on the back for a perfect and homogeneous internal temperature;
- hot gas defrost and automatic evaporation of condensation water;
- ergonomic handles;
- standard power supply 230V/50Hz;
- cooling gas R290;
- upper and lower door hinges fixed frontally to the frame (replaceable with no need to remove the worktop);
- reversible doors.

EN



FR

COMPACT est né pour offrir en une unique solution tous les avantages et la praticité d'un emplacement de travail ILSA pour la préparation de pizzas, de sandwichs, salades, amuse-gueules etc. Un seul moteur alimente l'élément réfrigéré en permettant une réduction considérable des dimensions.

- Finition extérieure en scotchbrite Satiné;
- épaisseur d'isolation de 60 mm pour le corps et 50 mm pour les portes avec mousse haute densité (40 kg/mc);
- dos extérieur en acier inox AISI 304 scotch-brite;
- pieds en acier inox réglable en hauteur H 140/230 mm;
- chambre froide avec coins arrondis pour un meilleur nettoyage intérieur;
- portes à fermeture automatique avec arrêt à 95°;
- joints magnétiques sur portes facilement amovibles;
- groupe frigorifique monobloc;
- système de ventilation canalisé à l'arrière pour une température interne parfaite et homogène;
- dégivrage par gaz chaud et évaporation automatique de l'eau de condensation;
- poignée ergonomique;
- alimentation standard 230V/50Hz;
- gaz réfrigérant R290.
- Charnières de porte supérieure et inférieure fixées à l'avant du corps (amovibles sans avoir à enlever le plan de travail);
- portes réversibles.

COMPACT wurde mit dem Ziel entwickelt, alle Vorteile des rationellen Arbeitsplatzes von ILSA für die Zubereitung von Pizzen, Sandwichs, Salaten, Tramezzini, usw. in einer einzigen Lösung zusammenzufassen. Nur ein Motor versorgt das Kühlelement und den Kühlaufsatz, wodurch die Abmessungen erheblich verringert werden.

- äußere satinierte Scotch-Brite Oberfläche;
- Isolierstärke von 60 mm für das Gehäuse und 50 mm für die Türen mit Schaumstoff hoher Dichte (40 kg/mc);
- äußere Rückseite aus Edelstahl AISI 304 Scotch-Brite;
- Füße aus Edelstahl höhenverstellbar H 140/230 mm;
- Zelle mit abgerundeten Ecken für eine bessere Innenreinigung;
- selbstschließende Türen mit 95°-Stopp;
- leicht abnehmbare Magnetdichtungen auf Türen;
- monoblock-Kühleinheit;
- kanalisiertes Belüftungssystem auf der Rückseite für eine perfekte und homogene Innentemperatur;
- Heißgasabtauung und automatisches Verdampfen von Kondenswasser;
- ergonomische Handgriffe;
- Standard-Stromversorgung 230V/50Hz.
- Kältemittel R290.
- Obere und untere Türbänder frontseitig am Körper befestigt (austauschbar, ohne die Arbeitsplatte abnehmen zu müssen);
- umkehrbare Türen.

DE



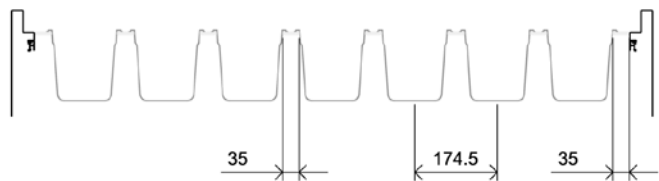
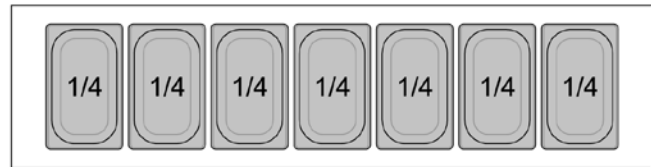
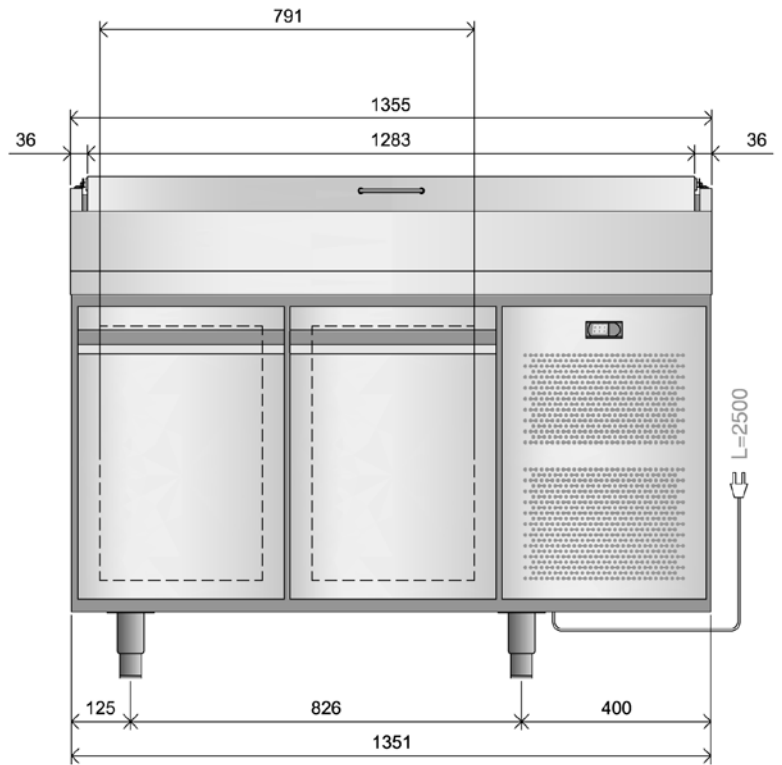
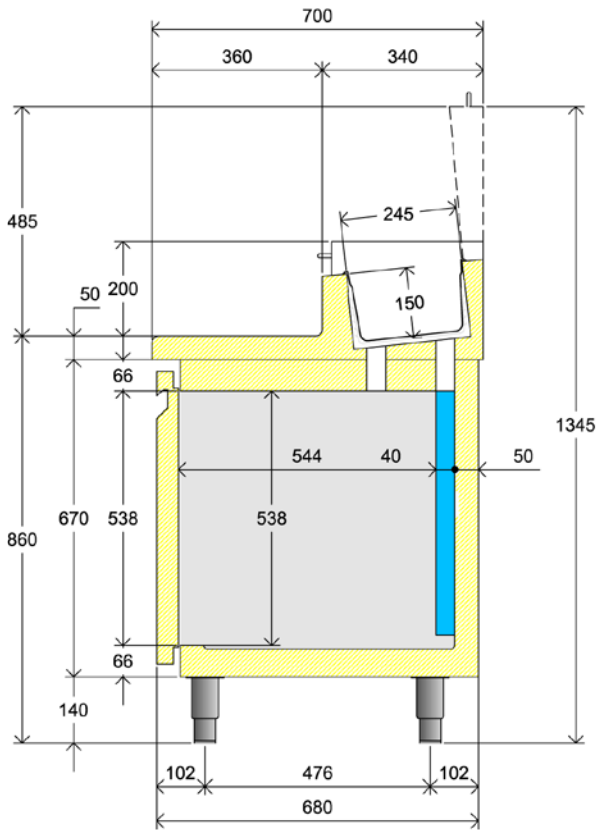

2 P 700

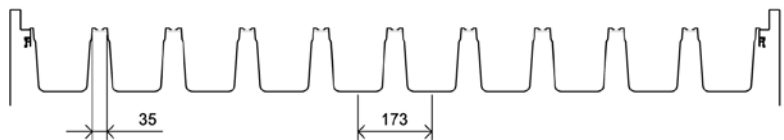
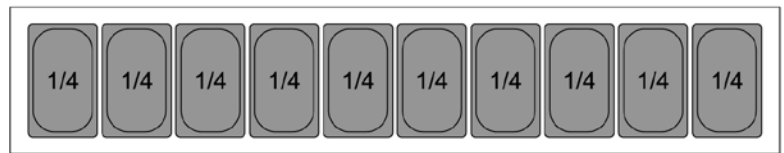
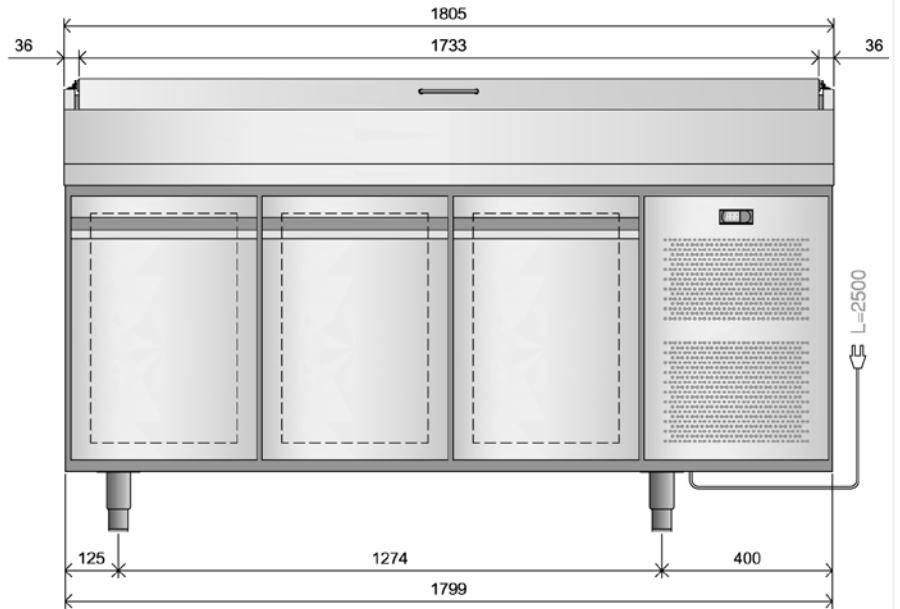
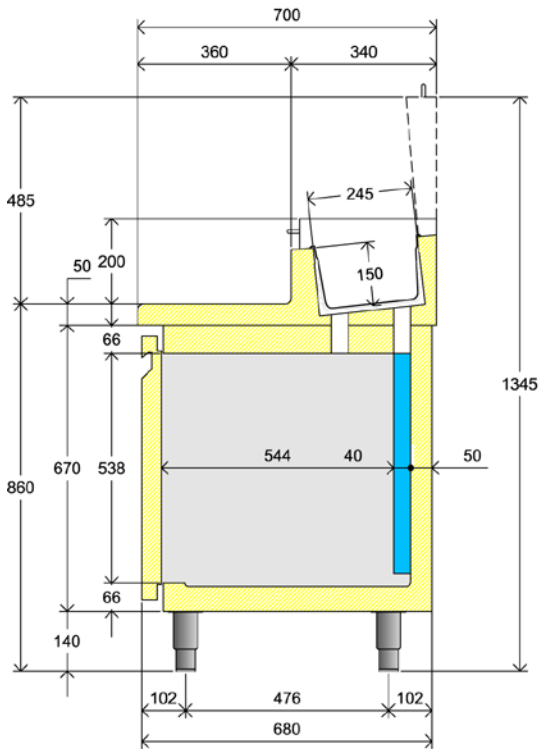



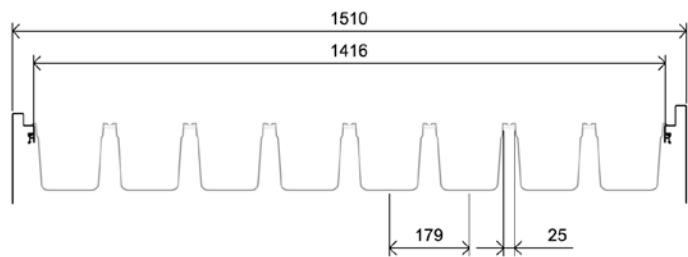
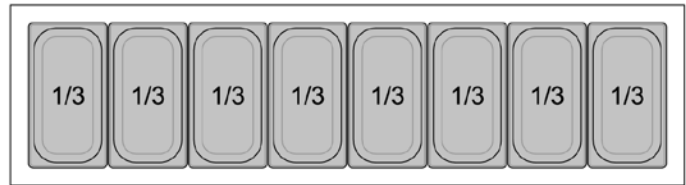
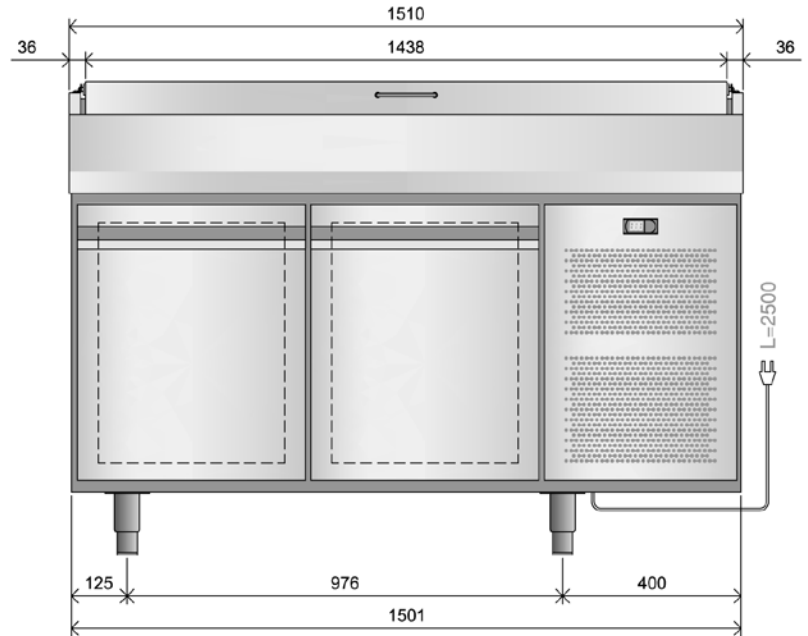
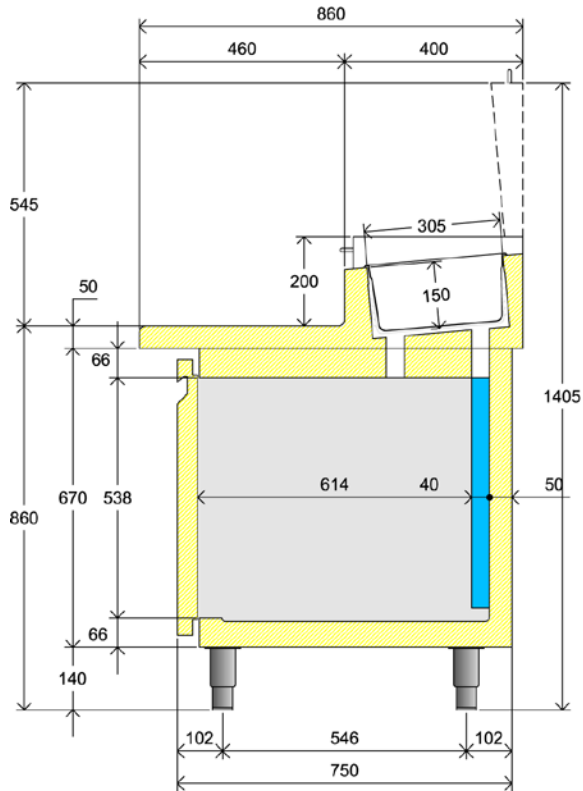



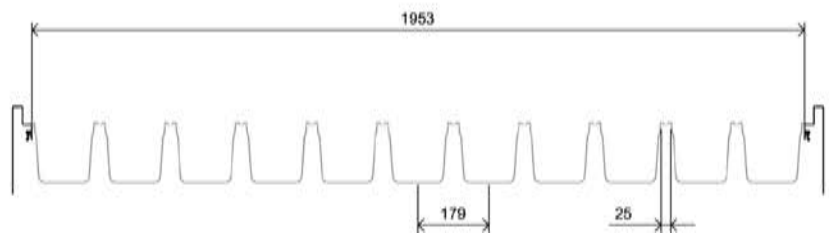
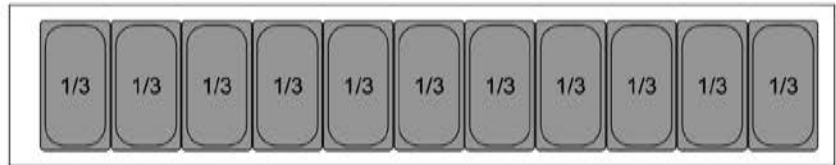
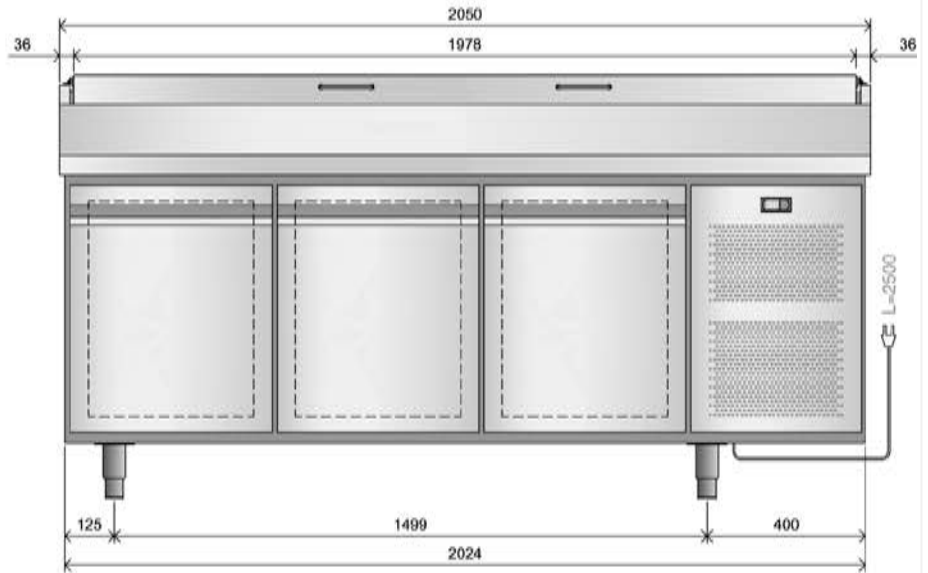
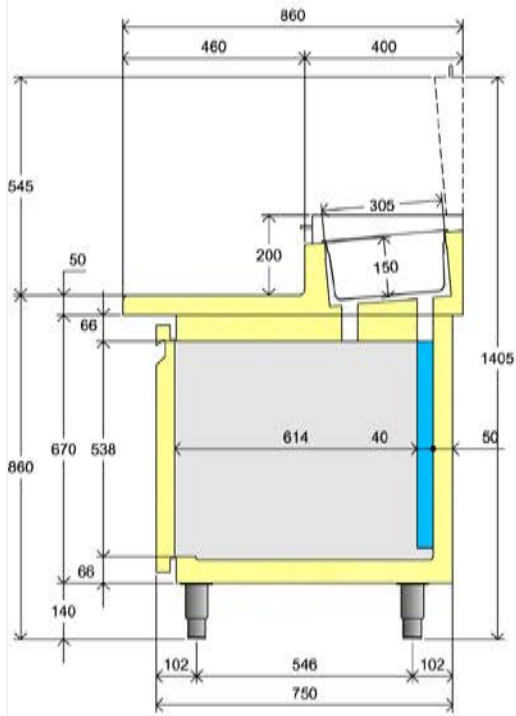









3 P 700



2 P 800



3 P 800

↓ Modello - Model Model - Gerätetyp		T N K G 2 V 2 5 0 0	T N K G 3 V 2 5 0 0
<h2>COMPACT GN 50 Hz</h2>			
 Descrizione - Description - Description - Beschreibung		2 doors	3 doors
 Range		-2°C...+8°C	-2°C...+8°C
 Funzionamento - Operating Mode - Mode de fonctionnement - Betriebsmodus S = Statico-Static-Statique-Stille Kühlung V = Ventilato-Ventilated-Ventile-Umluftkühlung	①	V	V
 Capacità lorda - Gross Capacity - Capacité brute - Bruttovolumen	l	226	355
 Dimensioni esterne - External Dimension - Dimensions externes - ußenabmessungen			
Lunghezza - Width - Largeur - Breite	mm	1355	1805
Profondità / con porte aperte - Depth / with open doors Profondeur avec portes ouverte - Tiefe/mit geöffneter Tü	mm	700/1090	700/1105
Altezza - Height - Hauteur - Höhe	mm	860 / 1060	860 / 1060
 Dimensioni interne - Internal Dimension - Dimensions internes - Innenabmessungen			
Lunghezza - Width - Largeur - Breite	mm	791	1239
Profondità - Depth - Profondeur - Tiefe	mm	530	530
Altezza - Height - Hauteur - Höhe	mm	540	540
 Porte - Doors - Portes - Türen		2	3
Dotazione Standard - Standard Equipment - Equipement standard - Standardausstattung		Griglia plastificata - Plastic-Coated Grid Grille Plastifíee - Kunststoff-Beschichtetes Gitter	
		2 - GN1/1	3 - GN1/1
N°Bacinelle - Advised N° of containers - N° Conseille de Bacs - Geratene zahl der Behälter		Bacinelle non include - Containers are not included Bacs GN pas compris - GN Behälter sind nicht im preis inbegriffen	
		7 - GN 1/4	10 - GN 1/4
 Serratura - Lock - Serrure - Schloss	②	<input type="checkbox"/>	<input type="checkbox"/>
 Sbrinamento - Defrost - Dégivrages - Abtauen		Gas caldo - Hot gas - Gaz chaude - Heissem Gas	
Type		Gas caldo - Hot gas - Gaz chaude - Heissem Gas	
N° Defrost in 24 hrs.		4	4
Evaporazione acqua sbrinamento - Evaporation of defrost water Evaporation eau de dégivrage - Tauwasserverdunstung		Gas caldo - Hot gas - Gaz chaude - Heissem Gas	
 Compressor			
Model		EMX6210U	
Potenza - Power - Puissance - Leistung	HP	1/3	
T° Evaporation	°C	-10	
Potenza frigorifera - Refrigerant Power - Puissance frigorifique - Kälteleistung	watt	780	
 Refrigerante - Refrigerant type - Réfrigérant type - Kältemitteltyp		R290 (GWP 3)	
Quantità di refrigerante - Refrigerant quantity - Quantité de réfrigérant - Kältemittelmenge	gr	130	
 Potenza assorbita - Total Power - Puissance - Leistung	watt	430W - 2,3A	430W - 2,3A
Tensione alimentazione - Supply Voltage - Tension d'alimentation - Anschlussspannung	V	230V~ 50Hz	
 Peso Netto - Net weight - Poids net - Netto Gewicht	kg	209	259
 Classe Climatica - Climate Class - Classe Climatique - Klima Classe		4 +30°C 55%	
		● = Dotazione di serie - Standard equipment - Dotation standard - Serien Ausstattung □ =Optional	

↓ Modello - Model Model - Gerätetyp	TNKP2V2500	TNKP3V2500
COMPACT PA 50 Hz		
Descrizione - Description - Description - Beschreibung	2 doors	3 doors
Range	-2°C...+8°C	-2°C...+8°C
Funzionamento - Operating Mode - Mode de fonctionnement - Betriebsmodus S = Statico-Static-Statique-Stille Kühlung V = Ventilato-Ventilated-Ventile-Umluftkühlung	V	V
Capacità lorda - Gross Capacity - Capacité brute - Bruttovolumen	293	457
Dimensioni esterne - External Dimension - Dimensions externes - ußenabmessungen		
Lunghezza - Width - Largeur - Breite	1510	2050
Profondità / con porte aperte - Depth / with open doors Profondeur avec portes ouverte - Tiefe/mit geöffneter Tü	860/1250	860/1250
Altezza - Height - Hauteur - Höhe	860 / 1060	860 / 1060
Dimensioni interne - Internal Dimension - Dimensions internes - Innenabmessungen		
Lunghezza - Width - Largeur - Breite	905	1410
Profondità - Depth - Profondeur - Tiefe	600	600
Altezza - Height - Hauteur - Höhe	540	540
Porte - Doors - Portes - Türen	2	3
Dotazione Standard - Standard Equipment - Equipement standard - Standardausstattung	Griglia plastificata - Plastic-Coated Grid Grille Plastifiée - Kunststoff-Beschichtetes Gitter	
	2 - 60x40	3 - 60x40
N°Bacinielle - Advised N° of containers - N° Conseille de Bacs - Geratene zahl der Behälter	Bacinielle non incluse - Containers are not included Bacs GN pas compris - GN Behälter sind nicht im preis inbegriffen	
	8 - GN 1/3	11 - GN 1/3
Serratura - Lock - Serrure - Schloss	<input type="checkbox"/>	<input type="checkbox"/>
Sbrinamento - Defrost - Dégivrages - Abtauen		
Type	Gas caldo - Hot gas - Gaz chaude - Heissem Gas	
N° Defrost in 24 hrs.	4	4
Evaporazione acqua sbrinamento - Evaporation of defrost water Evaporation eau de dégivrage - Tauwasserverdunstung	Gas caldo - Hot gas - Gaz chaude - Heissem Gas	
Compressor embraco		
Model	EMX6210U	
Potenza - Power - Puissance - Leistung	1/3	
T° Evaporation	-10	
Potenza frigorifera - Refrigerant Power - Puissance frigorifique - Kälteleistung	780	
Refrigerante - Refrigerant type - Réfrigérant type - Kältemitteltyp	R290 (GWP 3)	
Quantità di refrigerante - Refrigerant quantity - Quantité de réfrigérant - Kältemittelmenge	130	
Potenza assorbita - Total Power - Puissance - Leistung	450W - 2,4A	450W - 2,4A
Tensione alimentazione - Supply Voltage - Tension d'alimentation - Anschlussspannung	230V~ 50Hz	
Peso Netto - Net weight - Poids net - Netto Gewicht	236	311
Classe Climatica - Climate Class - Classe Climatique - Klima Classe	4 +30°C 55%	
● = Dotazione di serie - Standard equipment - Dotation standard - Serien Ausstattung □ =Optional		