



Catalogue :

SERIE 900 KORE

Chapter :

CHIPS SCUTTLE 900 KORE SERIES

Article :

MF-E905 380...415V 3N

Code:

19031443

<u>DIMENSIONS AND WEIGHTS</u>		<u>Net dimensions</u>	<u>Packed</u>
Length	mm	400,00	1.022,00
Depth	mm	930,00	440,00
Height	mm	290,00	685,00
Weight	kg	27,00	35,00
Volume	m3	0,11	0,31
<u>ELECTRICITY</u>		380...415V	50/60Hz
	Power		1,00 kW
Connections	230 V. 1+N+T		
	230 V. III+T	3X1,5MM2+T	
	400 V. III+N+T		
<u>GAS</u>	Not necessary		
<u>WATER</u>	Not necessary		
<u>STEAM</u>	Not necessary		
<u>AIR</u>	Not necessary		

DESCRIPTION

CHIP SCUTTLE, MF-E905

Chip scuttles are designed to keep the temperature of fresh fried chips or any other fried product from the fryer or frying pan.

Its perforated double bottom allows to get rid of any excess oil and collect it in a well. The product can be removed after it has been rinsed.

2 mm stainless AISI-304 steel top with rounded edges for easy cleaning.

Laser cut and automatic welding for a perfect adjustment of sides between modules with square angle finish.

Integrated AISI-304 stainless steel well with rounded edges for easy cleaning.

The well can be used with a 150 mm deep GN-1/1 container.

Perforated double bottom made of stainless steel. It is slanted to rinse excess oil and collect it in the container.

It keep the food's temperature by means of an infra-red light at the back of the container. The lamp is fitted with an ON/OFF switch.

Water-tight and protecting-support controls.

High temperature protector for the chimney made of enamelled cast iron.

Front access to components.

According to European standards for components and panels temperature, efficiencies and combustion, and sanitary regulations (EN-60335 and EN-203)

IPX5 grade water protection equipment.

Maximum power: 1.0 kW

Dimensions: 400 x 930 x 290 mm.

SOUND LEVEL < 65,00 db

INSTALLATION - CONNECTIONS

► ELECTRICITY

SI

Ø



Catalogue :
SERIE 900 KORE

Chapter :
CHIPS SCUTTLE 900 KORE SERIES

Article :
MF-E905 380...415V 3N

Code :
19031443

SCHEMA - DIMENSIONS

MF-E905

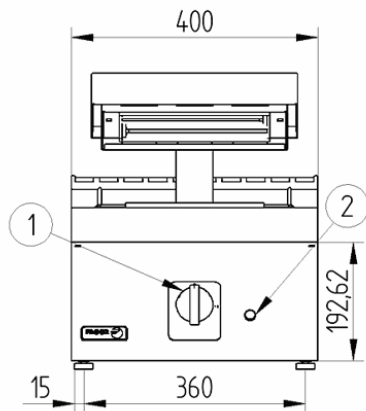

E. Conexión eléctrica
1. Mando eléctrico
2. Piloto ambar

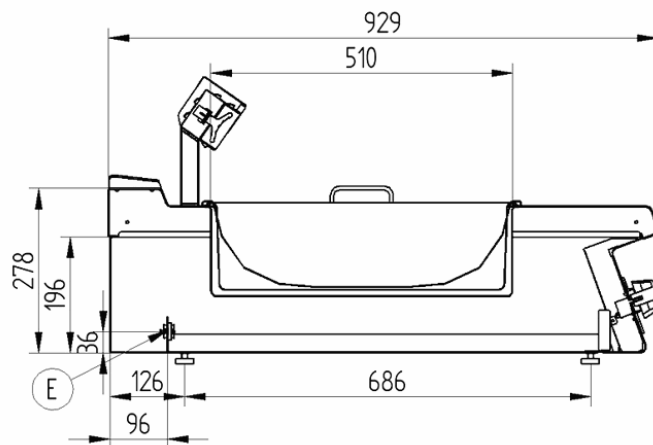

Electrical connection
Electric control
Ambar pilot