



MC-100  
MC-100-2



MC-150  
MC-150-2



MC-200  
MC-200-2

mod.	largo length (mm)	alto height (mm)	fondo depth (mm)	cajones drawers	tolva hopper	estantes shelves	puertas doors
MC-100	990	1040	600	1	1	1	1
MC-150	1495	1040	600	2	1	2	1
MC-200	2020	1040	600	2	1	2	1
MC-100-2	990	1040	600	1	1	2	1
MC-150-2	1495	1040	600	2	1	4	1
MC-200-2	2020	1040	600	2	1	4	1

Características técnicas y constructivas sujetas a variación sin previo aviso.

- Exterior en acero inox AISI-304, excepto el respaldo.
  - Respaldo en acero plastificado.
  - Apoyos inox, regulables en altura.
  - Cajones auxiliares sobre guías con rodamientos.
  - Tolva para café con golpeador.
  - MC - Un estante intermedio.
  - MC-2 - Dos estantes intermedios.
- Pueden fabricarse, bajo pedido, en diferentes medidas

We reserve the right to change specifications without prior notice.

- AISI-304 stainless steel exterior and shelf, except the rear side
  - Plasticised steel backing.
  - Height-adjustable stainless steel supports.
  - Auxiliary drawers on guides with wheels.
  - Coffee sediment special drawer with hitting surface
  - MC - One intermediate shelf.
  - MC-2 - Two intermediate shelves.
- Can be produced on request, in different measures

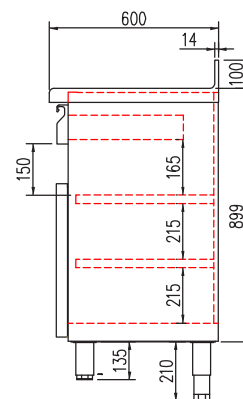
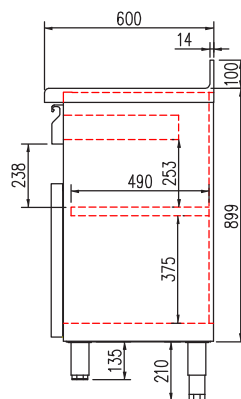
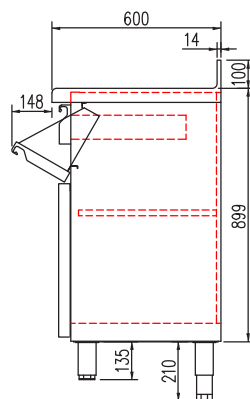

all photos must be considered as a reference - fotografías no contractuales



MC - 150



Forma línea con mesas frías gama FMR y FMRV, páginas 26 - 31 • Match with refrigerated counters FMR and FMRV pages 26-31